

VACUUM COVER

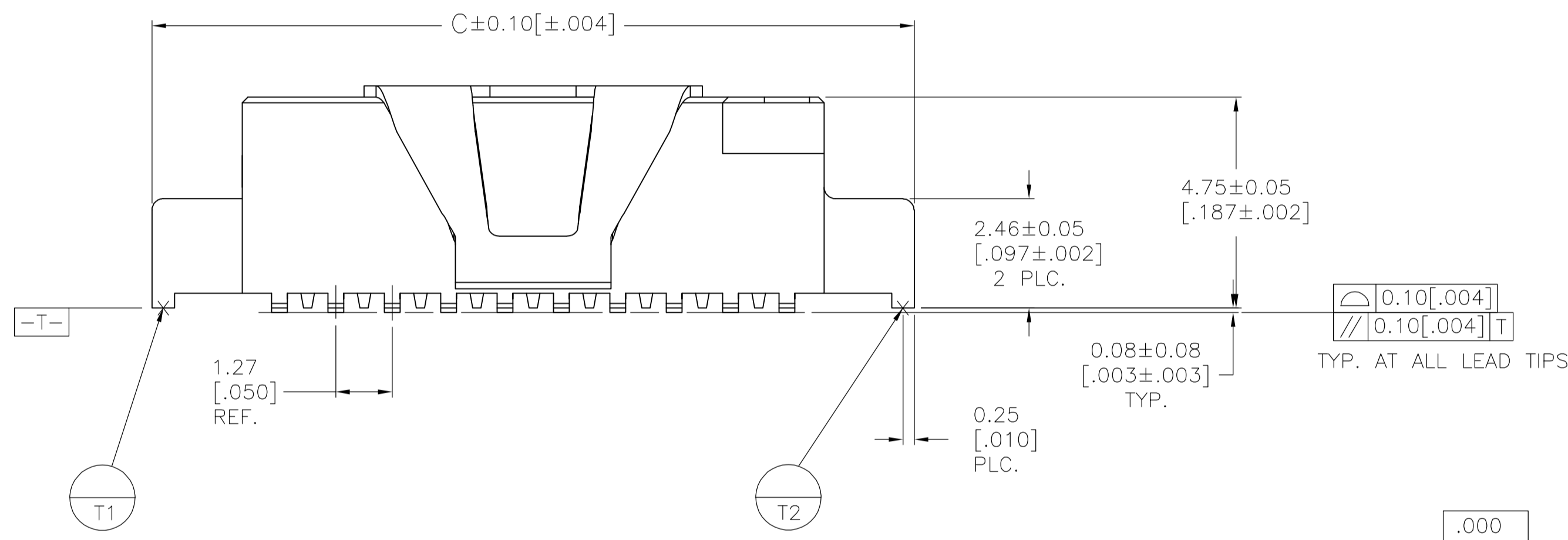

SECTION X-X

- 1 0.00076 [.000030] GOLD IN LOCALIZED GOLD PLATE AREA, 0.0038 [.000150] TIN-LEAD ON SOLDER LEADS, ALL OVER 0.00127 [.000050] NICKEL.
- 2 IF PLANNING TO USE MORE THAN ONE MATING PAIR OF CONNECTORS TO INTERCONNECT 2 BOARDS, PLEASE REFER TO THE SPACING PARAGRAPH IN APPLICATION SPEC.#114-7010.
- 3 VACUUM COVER SHOWN IN PHANTOM.
- 4 PACKAGED IN TAPE AND REEL PER EIA-481 SPECIFICATIONS, SEE CHART FOR TAPE WIDTHS.
- 5 VACUUM COVER DESIGNED FOR 4.0 [.160] DIA NOZZLE. VACUUM COVER TO BE REMOVED AFTER SOLDERING.
- 6 HOUSING: LCP, COLOR BLACK. CONTACT: COPPER ALLOY PER ASTM SPECIFICATION B422. VACUUM COVER: ALUMINUM ALLOY PER ASTM SPECIFICATION B209.
- 7 5.2 [.205] MIN. TARGET AREA FOR VACUUM PICK-UP.
- 8 0.00076(.000030) GOLD IN LOCALIZED GOLD PLATE AREA, 0.0038(.000150) TIN ON SOLDER LEADS, ALL OVER 0.00127(.000050) NICKEL.
- 9 ROHS 2002/95/EC COMPLIANT.

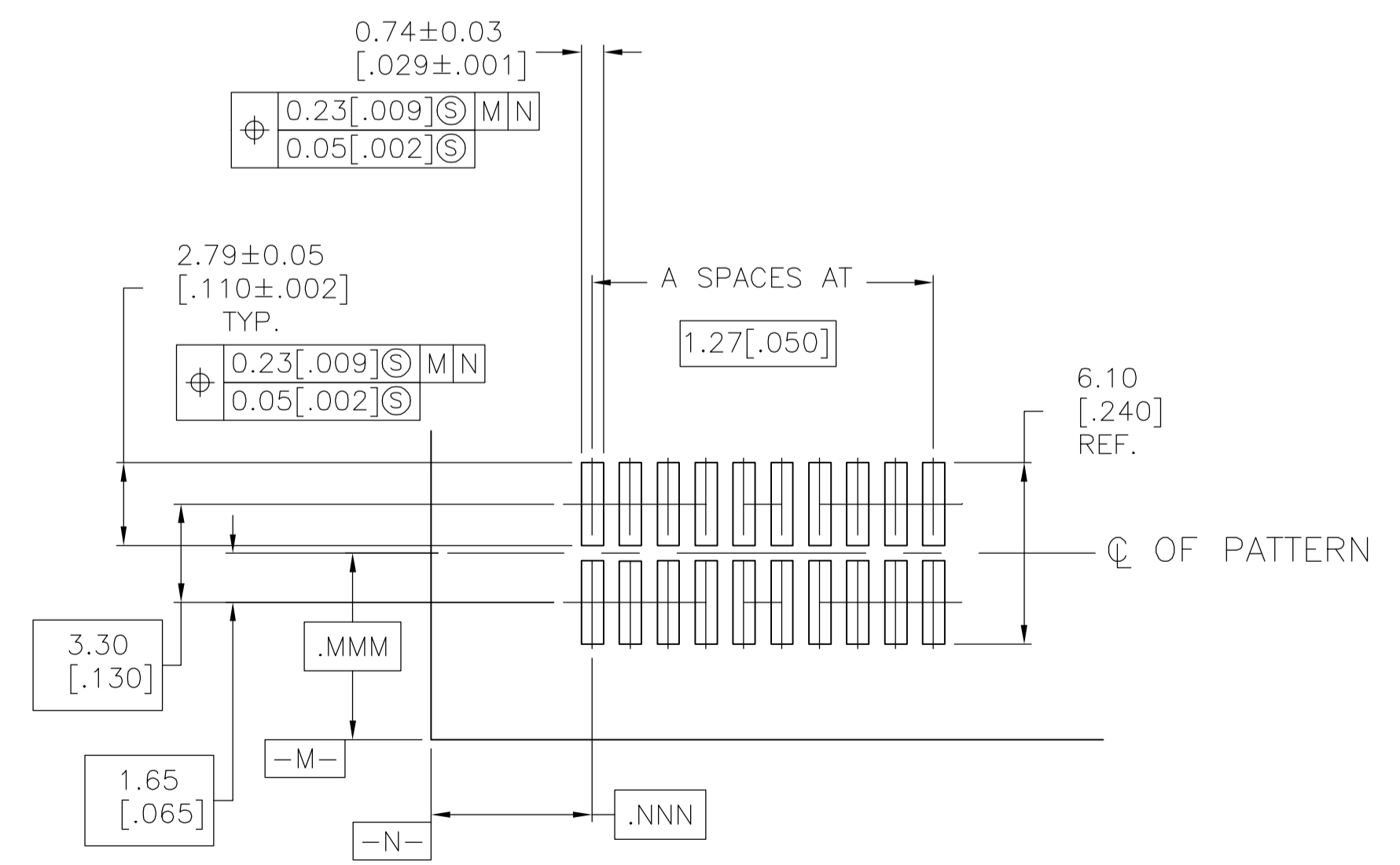

RECOMMENDED BOARD LAYOUT  
SCALE: 5:1

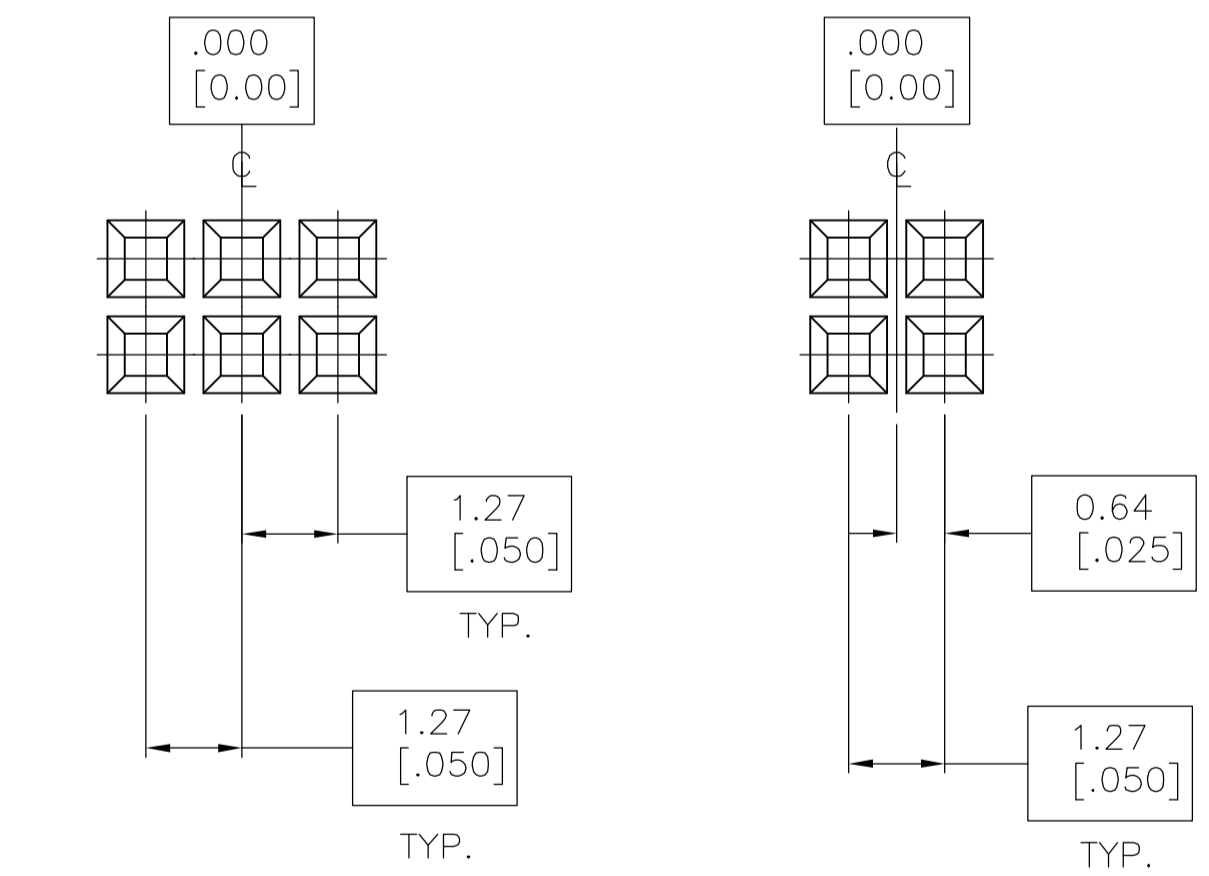

BASIC DIMENSIONS FOR EVEN NO. OF SPACES (SEE TABLE)  
 BASIC DIMENSIONS FOR ODD NO. OF SPACES (SEE TABLE)

DETAIL H

FINISH	TAPE WIDTH	D	C	B	A	NO. OF POS	PART NUMBER
8/9	44mm	10.41 [.410]	23.52 [.926]	19.46 [.766]	14	30	5-147413-4
8/9	32mm	7.24 [.285]	17.17 [.676]	13.11 [.516]	9	20	5-147413-3
8/9	56mm	16.76 [.660]	36.22 [1.426]	32.16 [1.266]	24	50	5-147413-2
8/9	32mm	4.06 [.160]	10.82 [.426]	6.75 [.266]	4	10	5-147413-1
1	44mm	10.41 [.410]	23.52 [.926]	19.46 [.766]	14	30	147413-4
1	32mm	7.24 [.285]	17.17 [.676]	13.11 [.516]	9	20	147413-3
1	56mm	16.76 [.660]	36.22 [1.426]	32.16 [1.266]	24	50	147413-2
1	32mm	4.06 [.160]	10.82 [.426]	6.75 [.266]	4	10	147413-1

THIS DRAWING IS A CONTROLLED DOCUMENT.

DIMENSIONS: mm [INCHES]  
 TOLERANCES UNLESS OTHERWISE SPECIFIED:  
 0 PLC ± -  
 1 PLC ± -  
 2 PLC ± -  
 3 PLC ± -  
 4 PLC ± -  
 ANGLES ± -

MATERIAL: 6  
 FINISH: SEE TABLE

THIS DRAWING IS A CONTROLLED DOCUMENT.  
 DWG: T. SMITH  
 CHK: D. SIMPSON  
 APVD: D.L. SIMPSON  
 NAME: D.L. SIMPSON  
 PRODUCT SPEC: 108-1332  
 APPLICATION SPEC: 114-7010  
 WEIGHT: -  
 CUSTOMER DRAWING:

Tyco Electronics Corporation  
 Harrisburg, Pa 17105-3608  
 ASSEMBLY, RECEPTACLE, VERTICAL, DOUBLE ROW, SURFACE MOUNT 50/50 GRID CONNECTOR  
 SIZE: A1  
 CAGE CODE: 00779  
 DRAWING NO: 147413  
 SCALE: 10:1  
 SHEET: 1 OF 1  
 REV: E2